

New Products 2019

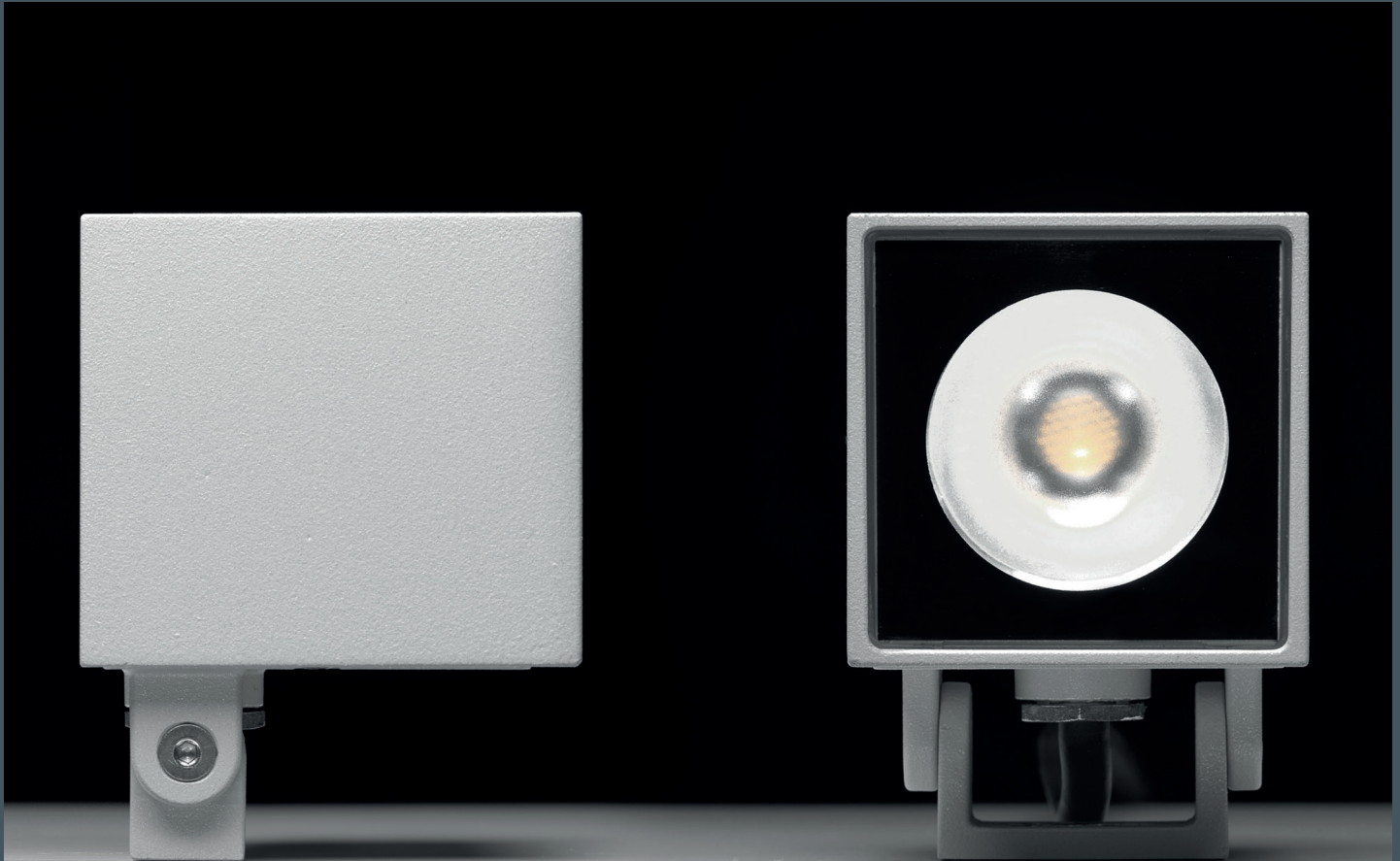

Nanocube is a new exterior luminaire series with minimalist design and compact dimensions. For this product range there is a choice of narrow beam, wide beam and asymmetrical light distributions. The luminaires can be integrated discreetly into the architectural environment and deliver high lumen output despite their miniature size. With integral LED drivers they can be directly connected to 230 V power supply.

actual size

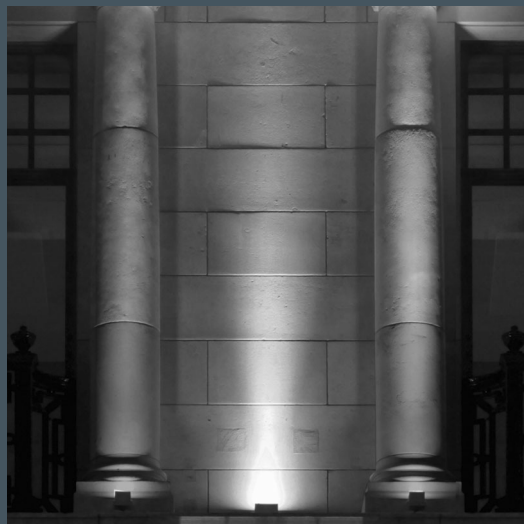

Nanocube brings miniaturization to the next level. The floodlights can be installed very discreetly.



In addition to floodlights for accent and landscape lighting there are versions for wall and ceiling mount applications.



For façade and sign illumination an unobtrusive wall arm is available as an accessory.

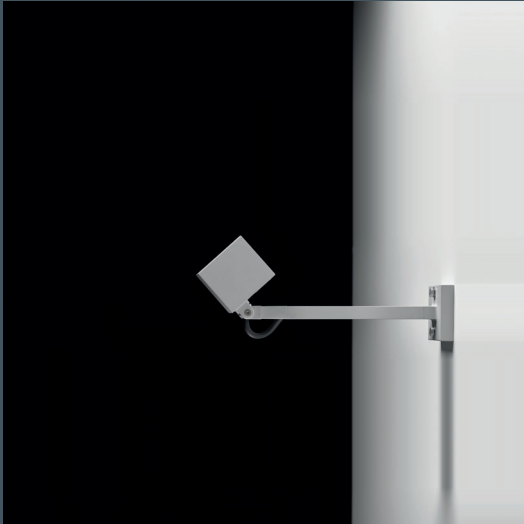

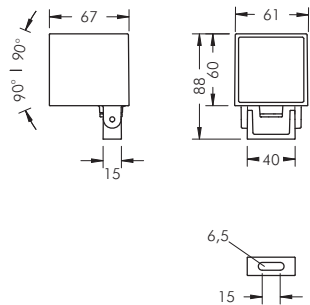

Nanocube with mounting bracket

Equipped with 1 x 5 W high performance LED, integral temperature monitoring device, CRI: > 80, colour tolerance: 3 SDCM service life: L90/B10 > 50 000 h protection class I, IP65 IK07 corrosion-resistant die cast aluminium housing AlSi12, polyester powder coated, highly efficient reflector, all exterior steel parts are stainless steel, tempered safety glass, silicon gasket, powder coated die cast aluminium mounting bracket:
 1 elongated holes \varnothing 6.5 mm, spacing 15 mm, tilt range 180°, M16 cable gland, with 0.8 m cable H05RN-F3G1, integral driver (AC/DC)

Nanocube, narrow beam

Part number	Colour	Light source	Luminous flux	Beam angle γ (FWHM)
8 308 046 019	black	1 x LED module 5 W	326 lm	6°
8 308 066 019	white	warm white (3000 K)		
8 308 056 019	silver grey			

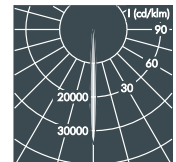
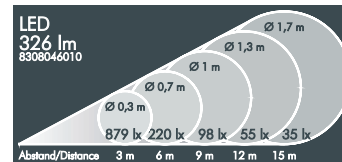

Part number	Colour	Light source	Luminous flux	Beam angle γ (FWHM)
8 308 045 019	black	1 x LED module 5 W	342 lm	6°
8 308 065 019	white	neutral white (4000 K)		
8 308 055 019	silver grey			

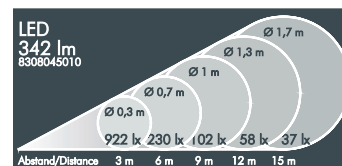

Nanocube, linear beam spread, vertical

Part number*	Colour	Light source	Luminous flux	Beam angle γ (FWHM)
8 308 046 029	black	1 x LED module 5 W	316 lm	C 0 - 180
8 308 066 029	white	warm white (3000 K)		34°
8 308 056 029	silver grey			7°

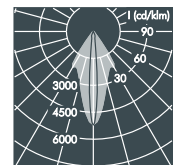
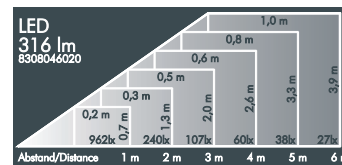

... .3. Luminaire with linear beam spread, horizontal

Nanocube, medium wide beam

Part number	Colour	Light source	Luminous flux	Beam angle γ (FWHM)
8 308 046 049	black	1 x LED module 5 W	330 lm	37°
8 308 066 049	white	warm white (3000 K)		
8 308 056 049	silver grey			

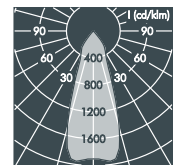
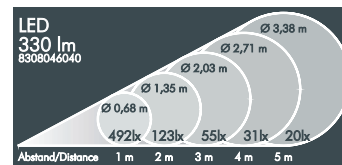

Part number	Colour	Light source	Luminous flux	Beam angle γ (FWHM)
8 308 045 049	black	1 x LED module 5 W	347 lm	37°
8 308 065 049	white	neutral white (4000 K)		
8 308 055 049	silver grey			

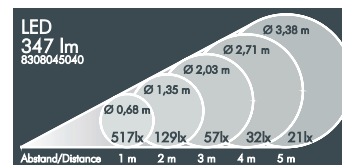

Nanocube, axially symmetrical wide beam

Part number*	Colour	Light source	Luminous flux	Beam angle γ (FWHM)
8 308 046 059	black	1 x LED module 5 W	356 lm	C 0 - 180
8 308 066 059	white	warm white (3000 K)		66°
8 308 056 059	silver grey			64°

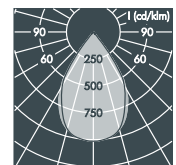
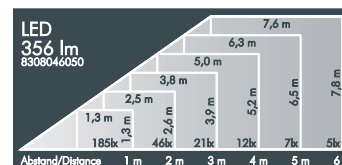

Nanocube, asymmetrical wide beam

Part number*	Colour	Light source	Luminous flux	Main beam angle γ
8 308 046 089	black	1 x LED module 5 W	236 lm	28°
8 308 066 089	white	warm white (3000 K)		
8 308 056 089	silver grey			

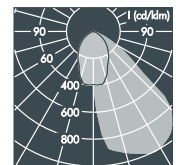
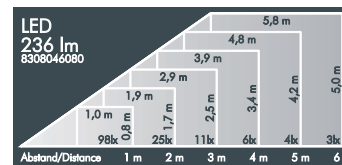

* The luminaires are available with neutral white LEDs (4000 K) upon request.

LED

Luminaires available in 2700 K and other colour temperatures on request



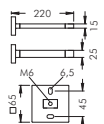

Accessories Nanocube		
Part number	Colour	Description
123 0 467 940	black	Wall arm 220 mm,
123 0 467 960	white	aluminium, polyester powder coated
123 0 467 950	silver grey	

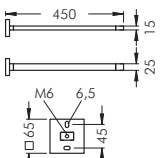

Part number	Colour	Description
123 0 468 940	black	Wall arm 450 mm,
123 0 468 960	white	aluminium, polyester powder coated
123 0 468 950	silver grey	

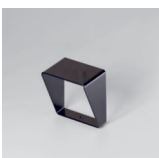

Part number	Colour	Description
123 0 490 940	black	Cowl, stainless steel,
123 0 490 960	white	to avoid glare from 3 directions
123 0 490 950	silver grey	

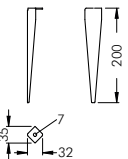

Part number	Colour	Description
123 0 470 940	black	Earth spike, stainless steel,
123 0 470 960	white	for use in landscaped areas
123 0 470 950	silver grey	



Part number	Colour	Description
123 0 510 941	black	Carrier frame,
123 0 510 961	white	with safety glass,
123 0 510 951	silver grey	for colour filters, lenses and plastic film



Part number	Description
238 1 222 000	Honeycomb louvre, internal (factory fitted, not for retro-fitting), to avoid glare

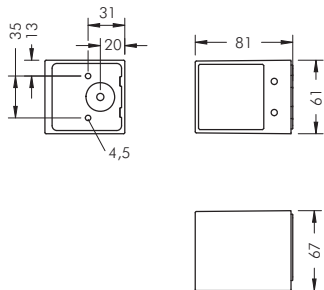

Nanocube wall luminaire

Equipped with 1 x 5 W high performance LED, integral temperature monitoring device, CRI: > 80, colour tolerance: max. 3 SDCM service life: L90/B10 > 50 000 h protection class I, IP65 , IK07 corrosion-resistant die cast aluminium housing AlSi12, polyester powder coated, highly efficient reflector, all exterior steel parts are stainless steel, tempered safety glass, silicon gasket, closure with grub screw, mounting: 2 drilled holes \varnothing 4.5 mm, spacing 35 mm, cable entry for recessed cable \varnothing 7-10 mm, integral driver (AC/DC)

Nanocube wall luminaire, narrow beam

Part number	Colour	Light source	Luminous flux	Beam angle γ (FWHM)
8 308 146 019	black	1 x LED module 5 W	326 lm	6°
8 308 166 019	white	warm white (3000 K)		
8 308 156 019	silver grey			

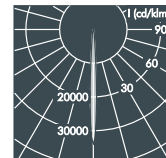
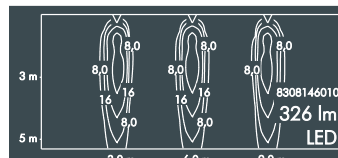

Part number	Colour	Light source	Luminous flux	Beam angle γ (FWHM)
8 308 145 019	black	1 x LED module 5 W	342 lm	6°
8 308 165 019	white	neutral white (4000 K)		
8 308 155 019	silver grey			

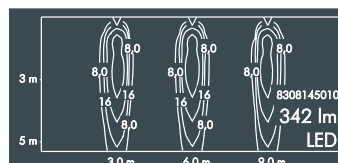

Nanocube wall luminaire, medium wide beam

Part number	Colour	Light source	Luminous flux	Beam angle γ (FWHM)
8 308 146 049	black	1 x LED module 5 W	330 lm	37°
8 308 166 049	white	warm white (3000 K)		
8 308 156 049	silver grey			

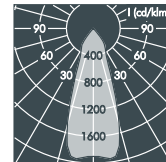
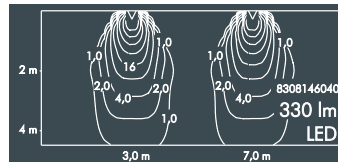

Part number	Colour	Light source	Luminous flux	Beam angle γ (FWHM)
8 308 145 049	black	1 x LED module 5 W	347 lm	37°
8 308 165 049	white	neutral white (4000 K)		
8 308 155 049	silver grey			

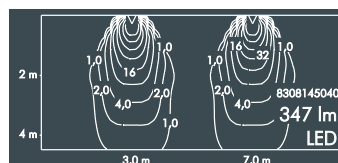

Nanocube wall luminaire, axially symmetrical wide beam

Part number*	Colour	Light source	Luminous flux	Beam angle γ (FWHM)
8 308 146 059	black	1 x LED module 5 W	356 lm	66°
8 308 166 059	white	warm white (3000 K)		
8 308 156 059	silver grey			

* The luminaires are available with neutral white LEDs (4000 K) upon request.

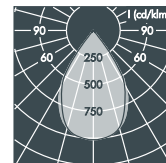
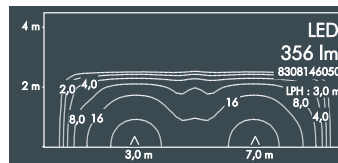

Nanocube wall luminaire, asymmetrical wide beam

Part number	Colour	Light source	Luminous flux	Main beam angle γ
8 308 146 089	black	1 x LED module 5 W	236 lm	28°
8 308 166 089	white	warm white (3000 K)		
8 308 156 089	silver grey			

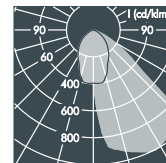
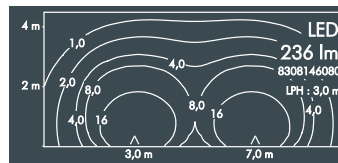

Part number	Colour	Light source	Luminous flux	Main beam angle γ
8 308 145 089	black	1 x LED module 5 W	248 lm	28°
8 308 165 089	white	neutral white (4000 K)		
8 308 155 089	silver grey			

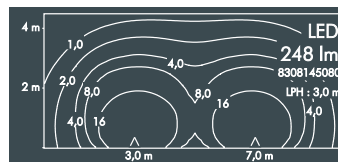

LED

Luminaires available in 2700 K and other colour temperatures on request



Nanocube ceiling luminaire

Equipped with 1 x 5 W high performance LED, integral temperature monitoring device, CRI: > 80, colour tolerance: max. 3 SDCM service life: L90/B10 > 50 000 h protection class I, IP65 \diamond \triangle \triangle , IK07 corrosion-resistant die cast aluminium housing AlSi12, polyester powder coated, highly efficient reflector, all exterior steel parts are stainless steel, tempered safety glass, silicon gasket, closure with grub screw, mounting: 2 drilled holes \varnothing 4.5 mm, spacing 35 mm, cable entry for recessed cable \varnothing 7-10 mm, integral driver (AC/DC)

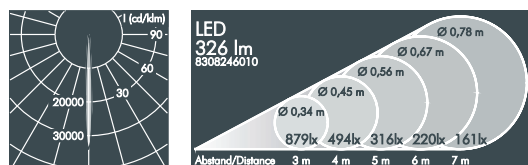
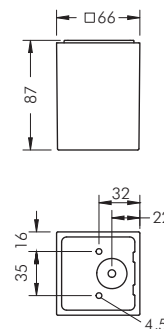

Nanocube ceiling luminaire, narrow beam

Part number	Colour	Light source	Luminous flux	Beam angle γ (FWHM)
8 308 246 019	black	1 x LED module 5 W	326 lm	6°
8 308 266 019	white	warm white (3000 K)		
8 308 256 019	silver grey			

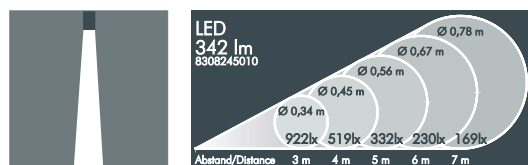

Part number	Colour	Light source	Luminous flux	Beam angle γ (FWHM)
8 308 245 019	black	1 x LED module 5 W	342 lm	6°
8 308 265 019	white	neutral white (4000 K)		
8 308 255 019	silver grey			

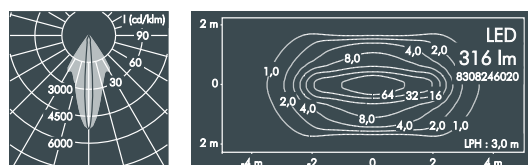

Nanocube ceiling luminaire, linear beam spread, 90° adjustable

Part number*	Colour	Light source	Luminous flux	Beam angle γ (FWHM)
8 308 246 029	black	1 x LED module 5 W	316 lm	C 0 – 180
8 308 266 029	white	warm white (3000 K)		34°
8 308 256 029	silver grey			7°

* The luminaires are available with neutral white LEDs (4000 K) upon request.

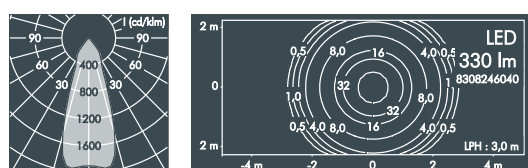

Nanocube ceiling luminaire, medium wide beam

Part number	Colour	Light source	Luminous flux	Beam angle γ (FWHM)
8 308 246 049	black	1 x LED module 5 W	330 lm	37°
8 308 266 049	white	warm white (3000 K)		
8 308 256 049	silver grey			

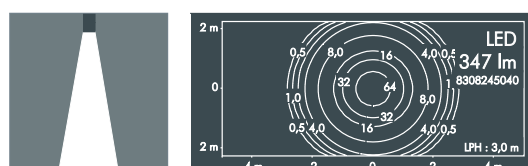

Part number	Colour	Light source	Luminous flux	Beam angle γ (FWHM)
8 308 245 049	black	1 x LED module 5 W	347 lm	37°
8 308 265 049	white	neutral white (4000 K)		
8 308 255 049	silver grey			

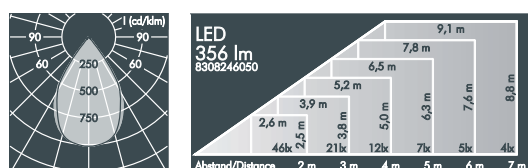

Nanocube ceiling luminaire, axially symmetrical wide beam

Part number	Colour	Light source	Luminous flux	Beam angle γ (FWHM)
8 308 246 059	black	1 x LED module 5 W	356 lm	C 0 – 180
8 308 266 059	white	warm white (3000 K)		66°
8 308 256 059	silver grey			64°

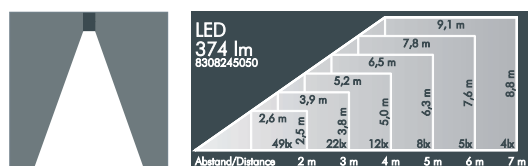

Part number	Colour	Light source	Luminous flux	Beam angle γ (FWHM)
8 308 245 059	black	1 x LED module 5 W	374 lm	C 0 – 180
8 308 265 059	white	neutral white (4000 K)		66°
8 308 255 059	silver grey			64°

LED

Luminaires available in 2700 K and other colour temperatures on request



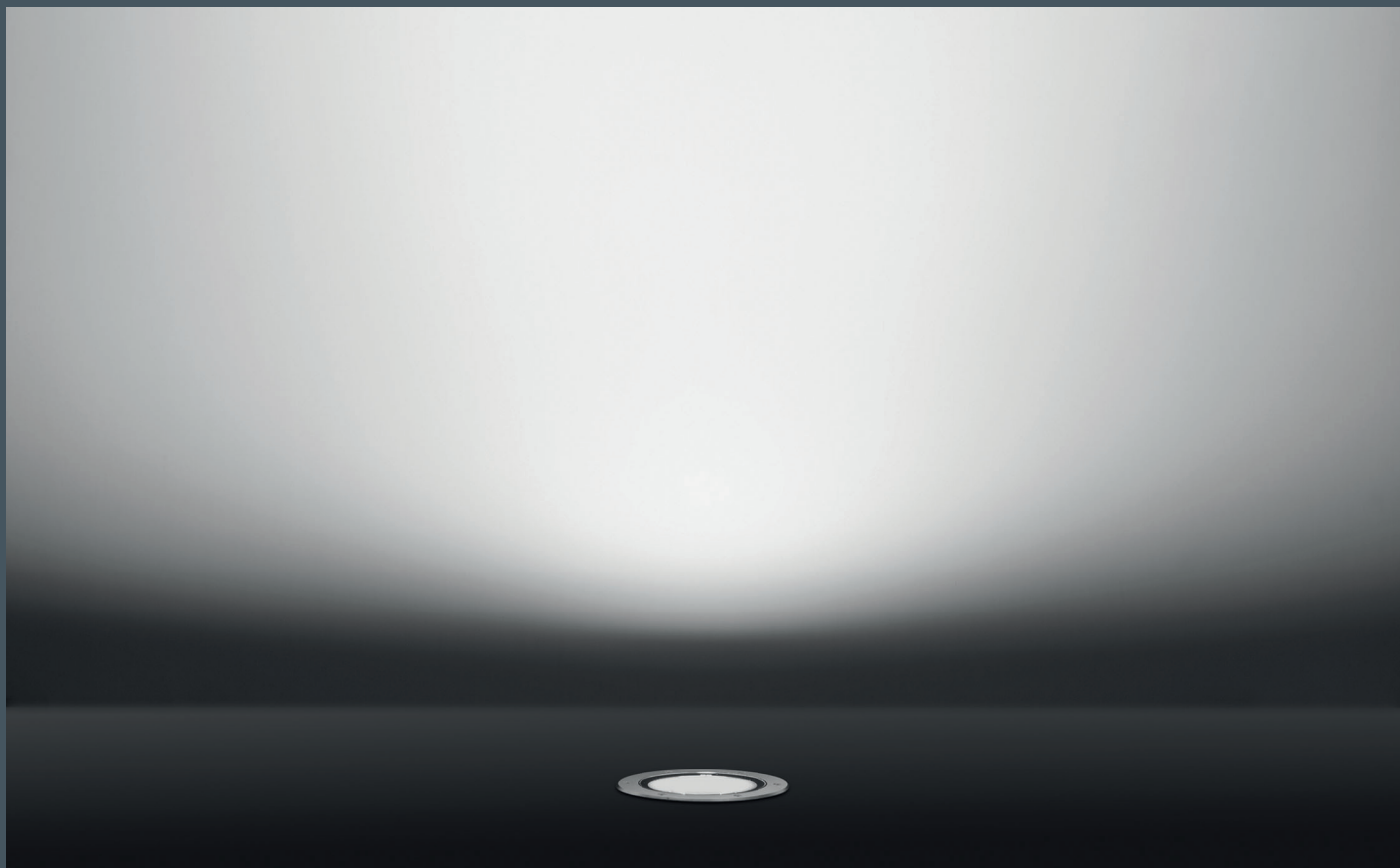

The Uplight product range is now available with innovative wall washer optics. They create uniform illumination from the bottom to the top of the façade. Thanks to adjustable optics the beam orientation can be adapted to different distances and wall sizes. The shallow recess depth makes an easy installation possible.

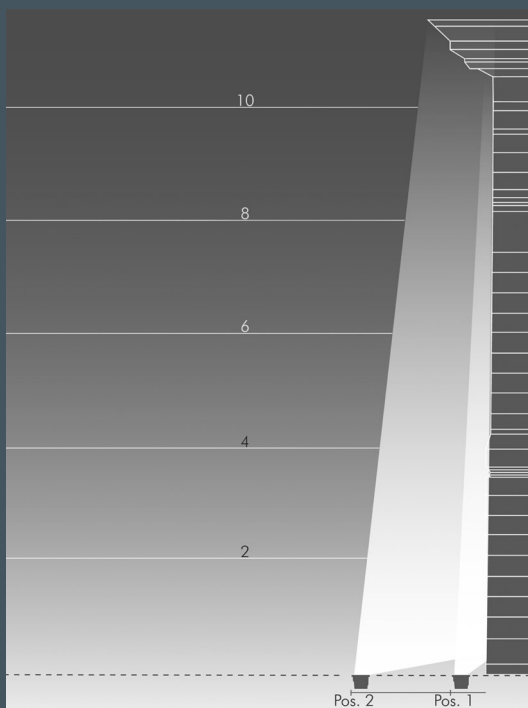

The adjustable optics allow for ideal beam orientation from a given luminaire position –
from a short distance to the façade (Pos. 1, min. 0.2 m)
and from a longer range (Pos. 2, max. 2.0 m).

Denekamp, Netherlands
Lighting design: Studio DL, Hildesheim



Uplight 180 adjustable optics, wall washer

With a high performance LED module (Zhaga), integral temperature monitoring device, CRI: > 80, colour tolerance: 3 SDCM service life: L90/B10 > 50 000 h Protection class I, IP68 (1.5 m) ♦♦♦, IK10 corrosion-resistant die cast aluminium housing AlSi12, double polyester powder coated, highly efficient aluminium reflector, wall washer lens with optical structure, adjustable glare shield, tilt range 0-13°, lockable, all exterior steel parts are stainless steel, tempered safety glass flush with frame, for loads up to max. 5000 kg (according to IEC/EN 60598-2-13), silicon gasket, V4A stainless steel trim ring and closure with 6 screws (V4A), M20 cable gland, with 0.8 m cable H07RN-F3G1, integral driver (AC/DC)

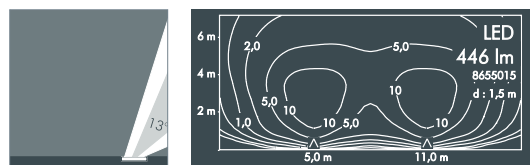
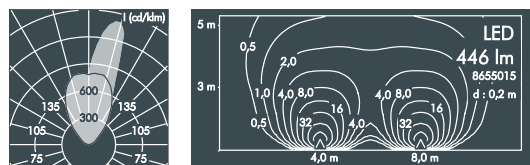
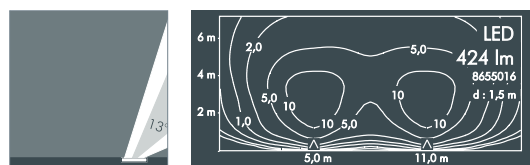
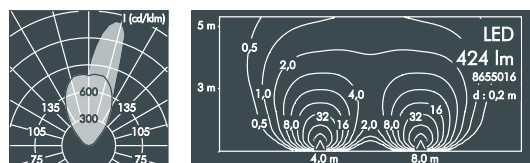
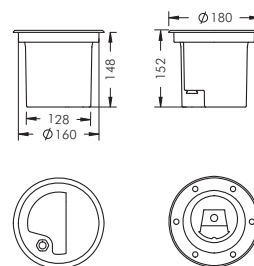

The adjustable glare shield reduces spill light and light pollution.

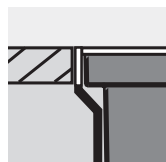
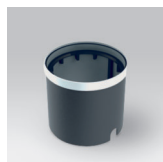
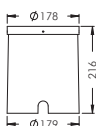
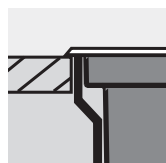
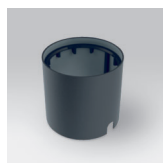
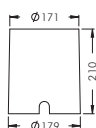
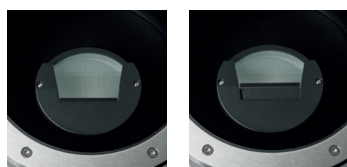

Uplight 180, adjustable optics, wall washer

Part number	light source	Luminous flux	Tilt range	Beam angle γ (FWHM)	
8 655 016 009	1 x LED module 11 W warm white (3000 K)	424 lm	0 – 13°	C 0 – 180	C 90 – 270

Part number	light source	Luminous flux	Tilt range	Beam angle γ (FWHM)	
8 655 015 009	1 x LED module 11 W neutral white (4000 K)	446 lm	0 – 13°	C 0 – 180	C 90 – 270

Part number	Description
... 1 ...	Luminaire with slip resistant glass* (R13 according to DIN EN 51130)

*The light distribution becomes more diffuse.

Part number	Description
8 656 ...	Luminaire for installation flush with surrounding surface (in combination with installation sleeve 126 0 371 060)

Accessories Uplight 180

Part number	Description
126 0 371 000	Installation sleeve , polypropylene, for luminaire with overlapping trim (for luminaires 8 655 9)

Part number	Description
126 0 371 060	Installation sleeve , polypropylene, for luminaire with trim for flush mounting (for luminaires 8 656 9)

LED

Luminaires available in 2700 K or other colour temperatures on request



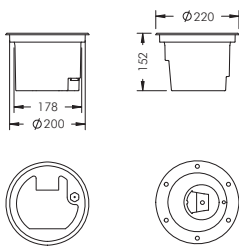

Uplight 220 adjustable optics, wall washer

With a high performance LED module (Zhaga), integral temperature monitoring device, CRI: > 80, colour tolerance: 2 SDCM service life: L90/B10 > 50 000 h Protection class I, IP68 (1.5 m) $\blacklozenge\blacklozenge\blacklozenge$, IK10 corrosion-resistant die cast aluminium housing AlSi12, double polyester powder coated, highly efficient aluminium reflector, wall washer lens with optical structure, adjustable glare shield, tilt range 0-20°, lockable, with Heatslide mechanism for optimal heat dissipation, all exterior steel parts are stainless steel, tempered safety glass flush with frame, for loads up to max. 5000 kg (according to IEC/EN 60598-2-13), silicon gasket, V4A stainless steel trim ring and closure with 6 screws (V4A), M20 cable gland, with 0.8 m cable H07RN-F3G1, integral driver (AC)

Uplight 220, adjustable optics, wall washer

Part number	Light source	Luminous flux	Tilt range	Beam angle γ (FWHM)	
				C 0 – 180	C 90 – 270
8 663 016 009	1 x LED module 19 W warm white (3000 K)	672 lm	0 – 20°	25°	75°

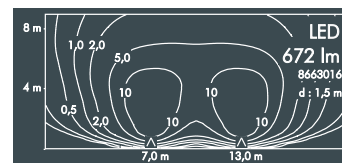
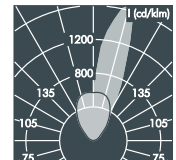
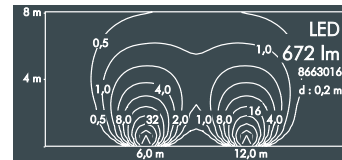

Part number	Light source	Luminous flux	Tilt range	Beam angle γ (FWHM)	
				C 0 – 180	C 90 – 270
8 663 015 009	1 x LED module 19 W neutral white (4000 K)	706 lm	0 – 20°	25°	75°

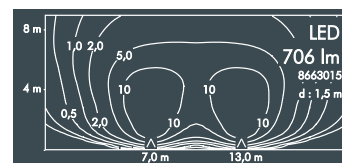
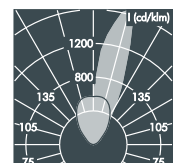
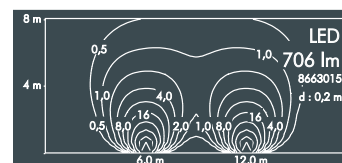

Part number	Description
... 1 ...	Luminaire with slip resistant glass* (R13 according to DIN EN 51130)
... .. 1 ..	Dimmable luminaire (DALI)
... .. 2 ..	Dimmable luminaire (1-10 V)
8 664	Luminaire for installation flush with surrounding surface (in combination with installation sleeve 126 0 338 060)

*The light distribution becomes more diffuse.

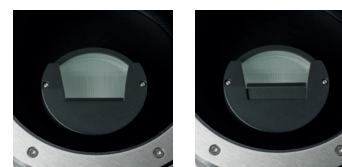

The adjustable glare shield reduces spill light and light pollution.

Accessories Uplight 220

Part number	Description
126 0 338 000	Installation sleeve , polypropylene, for luminaire with overlapping trim (for luminaires 8 663 9)

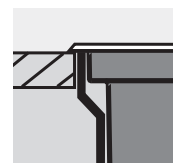
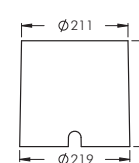
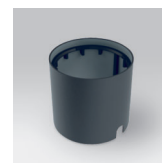

Part number	Description
126 0 338 060	Installation sleeve , polypropylene, for luminaire with trim for flush mounting (for luminaires 8 664 9)

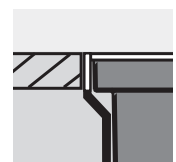
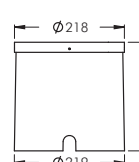
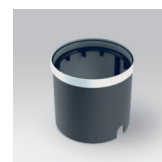

Uplight 260 adjustable optics, wall washer

With a high performance LED module (Zhaga), integral temperature monitoring device, CRI: > 80, colour tolerance: 2 SDCM service life: L90/B10 > 50 000 h Protection class I, IP68 (1.5 m) ♦♦♦, IK10 corrosion-resistant die cast aluminium housing AlSi12, double polyester powder coated, highly efficient aluminium reflector, wall washer lens with optical structure, adjustable glare shield, tilt range 0-18°, lockable, with Heatslide mechanism for optimal heat dissipation, all exterior steel parts are stainless steel, tempered safety glass flush with frame, for loads up to max. 4500 kg (according to IEC/EN 60598-2-13), silicon gasket, V4A stainless steel trim ring and closure with 6 screws (V4A), M20 cable gland, with 0.8 m cable H07RN-F3G1, integral driver

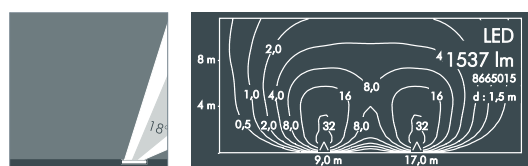
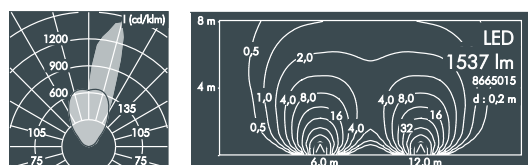
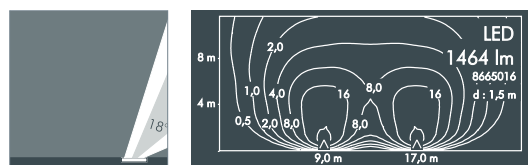
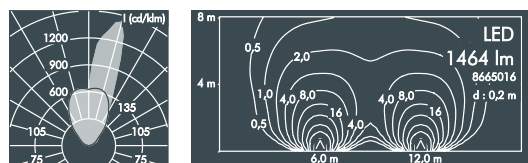
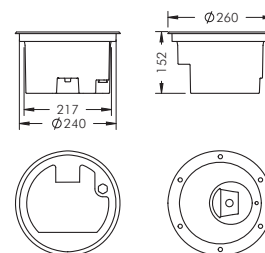

The adjustable glare shield reduces spill light and light pollution.

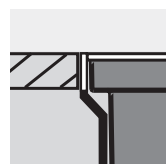
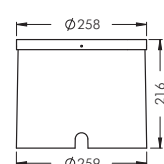
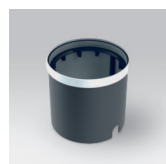
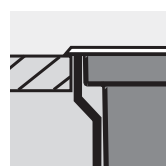
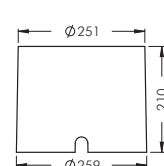
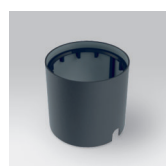
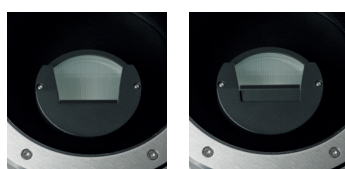

Uplight 260, adjustable optics, wall washer

Part number	light source	Luminous flux	Tilt range	Beam angle γ (FWHM)	
				C 0 – 180	C 90 – 270
8 665 016 009	1 x LED module 37 W warm white (3000 K)	1464 lm	0 – 18°	20°	78°

Part number	light source	Luminous flux	Tilt range	Beam angle γ (FWHM)	
				C 0 – 180	C 90 – 270
8 665 015 009	1 x LED module 37 W neutral white (4000 K)	1537 lm	0 – 18°	20°	78°

Part number	Description
... 1 ...	Luminaire with slip resistant glass* (R13 according to DIN EN 51130)
... 1 ..	Dimmable luminaire (DALI)
... 2 ..	Dimmable luminaire (1-10 V)
8 666	Luminaire for installation flush with surrounding surface (in combination with installation sleeve 126 0 341 060)

*The light distribution becomes more diffuse.

Accessories Uplight 260

Part number	Description
126 0 341 000	Installation sleeve , polypropylene, for luminaire with overlapping trim (for luminaires 8 665 9)

Part number	Description
126 0 341 060	Installation sleeve , polypropylene, for luminaire with trim for flush mounting (for luminaires 8 666 9)





For the Monospot series there is a gobo projector available with precise optics for sharpe-edged image projections. The optical system can accommodate gobos and colour filters simultaneously. With the help of a framer, the edges of the image can be defined and adapted to the size of the projection surface. The Monospot series thus offers many possibilities for imaginative illumination.



Monospot Gobo

With 1 x high performance LED module,
 CRI: > 70, colour tolerance: max. 4 SDCM
 service life: L70/B20 > 50 000 h
 protection class I, IP65 \blacklozenge \blacktriangle \blacktriangle , IK08
 windage area AW 0.074 m²,
 corrosion-resistant die cast aluminium housing AlSi12,
 polyester powder coated, focusable lens,
 carrier for gobos and colour filters,
 all exterior steel parts are stainless steel,
 tempered safety glass, silicon gasket,
 closure with 3 stainless steel screws,
 mounting bracket: 2 drilled holes \varnothing 7 mm,
 spacing 40 – 60 mm, 1 centre hole \varnothing 21 mm,
 tilt range 180°, M20 cable gland,
 integral driver (AC/DC)

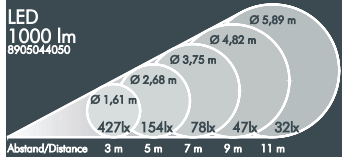
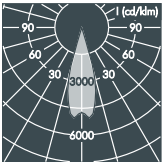
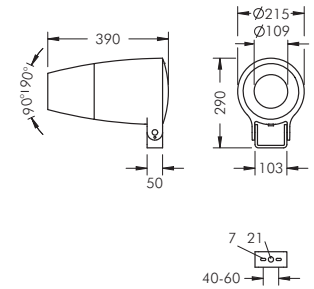

Monospot Gobo, 63 mm focal length

Part number	Colour	Light source	Luminous flux	Beam angle
8 905 044 059	black	1 x LED module 47 W	1000 lm	30°
8 905 064 059	white	cool white (6500 K)		
8 905 054 059	silver grey			

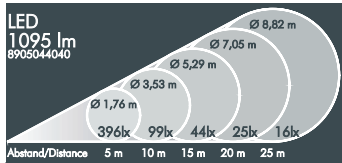
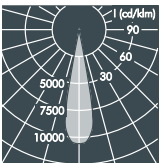

Monospot Gobo, 85 mm focal length

Part number	Colour	Light source	Luminous flux	Beam angle
8 905 044 049	black	1 x LED module 47 W	1095 lm	20°
8 905 064 049	white	cool white (6500 K)		
8 905 054 049	silver grey			

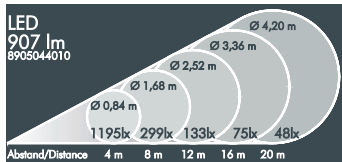
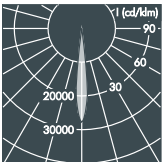

Monospot Gobo, 150 mm focal length

Part number	Colour	Light source	Luminous flux	Beam angle
8 905 044 019	black	1 x LED module 47 W	907 lm	12°
8 905 064 019	white	cool white (6500 K)		
8 905 054 019	silver grey			

Part number	Description
..... 1 ..	Dimmable version (DALI)
..... 2 ..	Dimmable version (1-10 V)



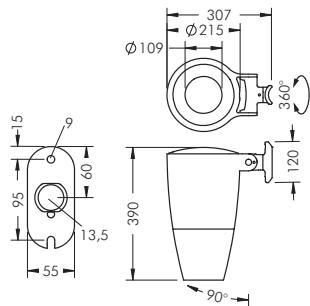

Monospot Gobo pole luminaire

With 1 x high performance LED module, CRI: > 70, colour tolerance: max. 4 SDCM service life: L70/B20 > 50 000 h protection class I, IP65 , IK08 windage area AW 0.076 m², corrosion-resistant die cast aluminium housing AlSi12, polyester powder coated, focusable lense, carrier for gobos and colour filters, all exterior steel parts are stainless steel, tempered safety glass, silicon gasket, closure with 3 stainless steel screws, for installation on poles Ø 60–100 mm, tiltable base made of powder coated aluminium, 2 drilled holes Ø 9 mm, spacing 95 mm, 1 drilled hole Ø 13.5 mm, tilt range 90°, swivel range 360°, M20 cable gland, integral driver (AC/DC)

Monospot Gobo pole luminaire, 63 mm focal length

Part number	Colour	Light source	Luminous flux	Beam angle
8 905 244 059	black	1 x LED module 47 W	1000 lm	30°
8 905 264 059	white	cool white (6500 K)		
8 905 254 059	silver grey			

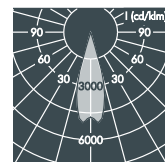
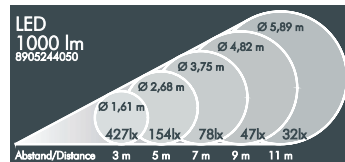

Monospot Gobo pole luminaire, 85 mm focal length

Part number	Colour	Light source	Luminous flux	Beam angle
8 905 244 049	black	1 x LED module 47 W	1095 lm	20°
8 905 264 049	white	cool white (6500 K)		
8 905 254 049	silver grey			

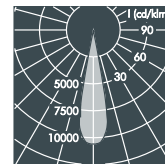
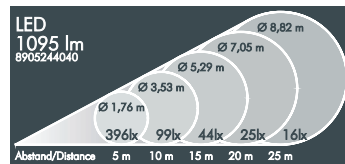

Monospot Gobo pole luminaire, 150 mm focal length

Part number	Colour	Light source	Luminous flux	Beam angle
8 905 244 019	black	1 x LED module 47 W	907 lm	12°
8 905 264 019	white	cool white (6500 K)		
8 905 254 019	silver grey			

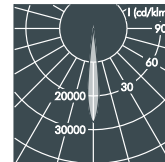
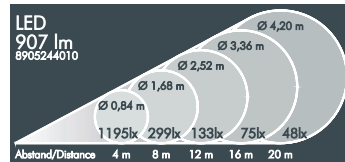

Part number	Description
. 1..	Dimmable version (DALI)
. 2..	Dimmable version (1-10 V)



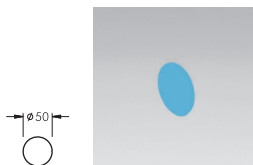

Accessories Monospot Gobo

Part number	Colour	Description
129 0 551 000	yellow	Dichroic colour filter
129 0 557 000	red	
129 0 553 000	blue	
129 0 558 000	green	

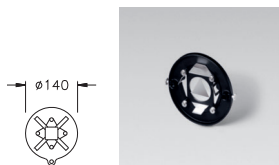

Part number	Description
129 0 257 000	Framer for sharp edges on 3- or 4-sided images



Part number	Example	Description
129 0 489 000	waves	Standard gobos Ø 50 mm
129 0 490 000	stars	
129 0 491 000	hash	

Custom made gobos can be produced from image data in one of the following file formats: **EPS** (min. 300 dpi), **TIF** (min. 300 dpi), **JPG** (in low compression).
Max. image size D on gobo: D = 38 mm (outer diameter gobo 50 mm)

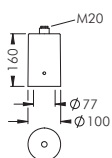
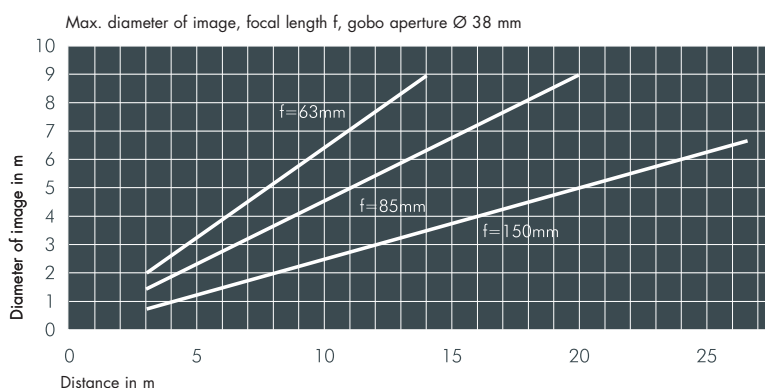

Part number	Colour	Description
128 0 626 940	black	Pole Top Filter , aluminium, for 76 mm pole top, with M20 x 1.5 connection thread, for installation of one projector with mounting bracket
128 0 626 960	white	
128 0 626 950	silver grey	





The compact Superlight Nano floodlight series is extended by a larger size version with high lumen output. Superlight Nano 5 is an ideal lighting tool for façade lighting on tall buildings and for accent lighting from long distances. There is a choice of optics with narrow beam, linear beam and wide beam control. With integral control gear a direct connection to mains voltage power supply is possible.

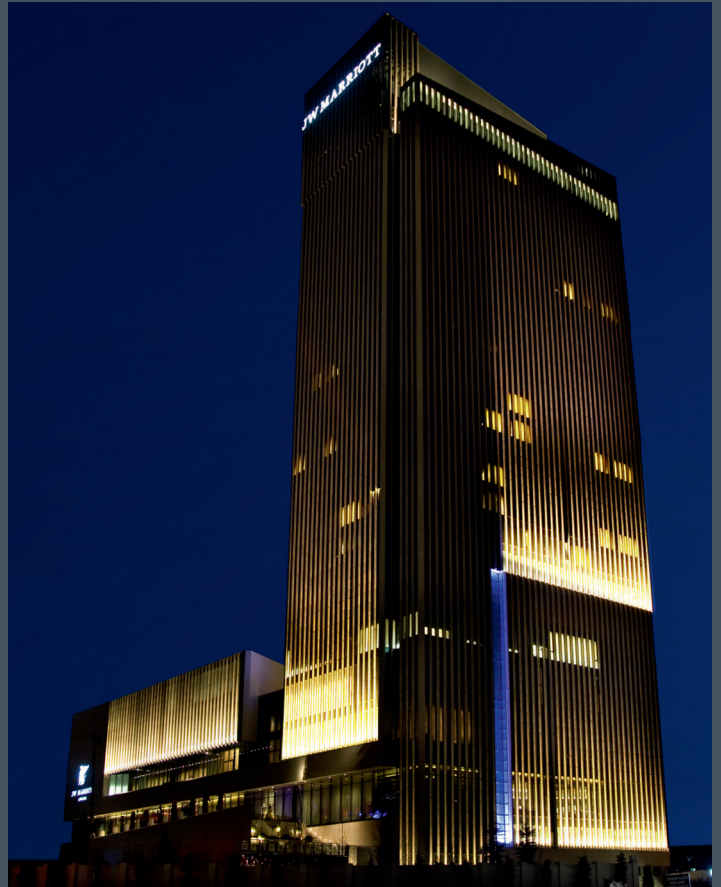

JW Marriott Hotel, Ankara, Turkey
Lighting design: dpa lighting consultants, London/Oxfordshire

Despite its high output this new floodlight has compact dimensions and can be installed discretely in any environment.

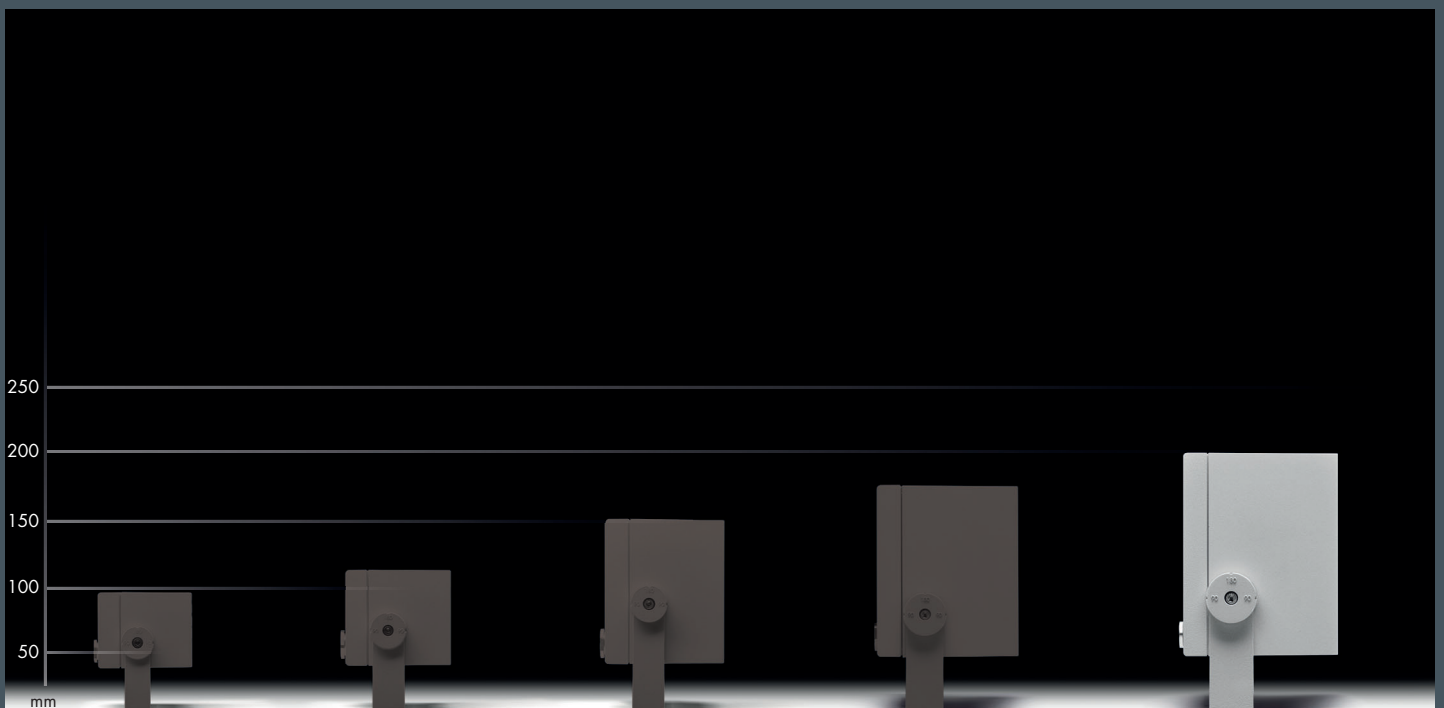

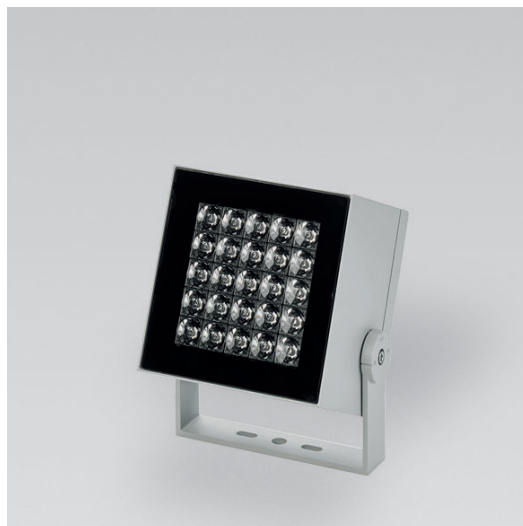
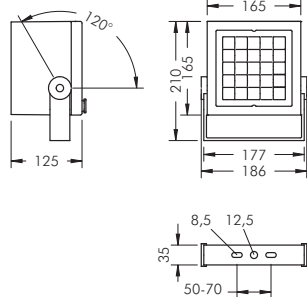

Superlight Nano 5

Equipped with 25 x 2.3 W high performance LEDs, integral temperature monitoring device, CRI: > 80, colour tolerance: max. 2 SDCM service life: L90/B10 > 50 000 h protection class I, IP65 , IK08 windage area AW 0.03 m² corrosion-resistant die cast aluminium housing AlSi12, polyester powder coated, all exterior steel parts are stainless steel, tempered safety glass, silicon gasket, powder coated die cast aluminium mounting bracket with tilt scale: 2 elongated holes Ø 8.5 mm, spacing 50-70 mm, 1 centre hole Ø 12.5 mm, tilt range 120°, M20 cable gland, integral driver (AC/DC)

Superlight Nano 5, narrow beam

Part number*	Colour	Light source	Luminous flux	Beam angle γ (FWHM)
8 830 046 019	black	25 x LED 2.3 W	3729 lm	6°
8 830 066 019	white	warm white (3000 K)		
8 830 056 019	silver grey			

8 830 045 019	black	25 x LED 2.3 W	3915 lm	6°
8 830 065 019	white	neutral white (4000 K)		
8 830 055 019	silver grey			

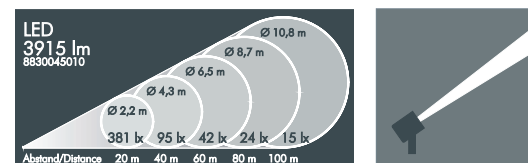
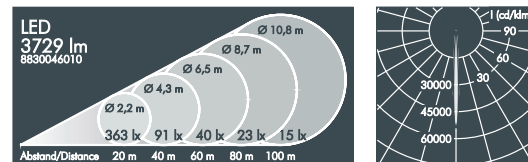

Superlight Nano 5, linear beam spread, vertical

Part number*	Colour	Light source	Luminous flux	Beam angle γ (FWHM)	
				C 0 - 180	C 90 - 270
8 830 046 029	black	25 x LED 2.3 W	3715 lm	42°	7°
8 830 066 029	white	warm white (3000 K)			
8 830 056 029	silver grey				

8 830 045 029	black	25 x LED 2.3 W	3901 lm	42°	7°
8 830 065 029	white	neutral white (4000 K)			
8 830 055 029	silver grey				

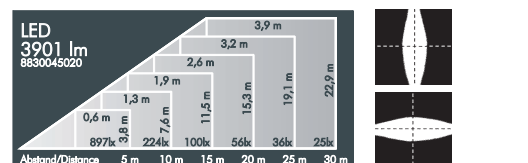

Part number*	Description
.3.	Luminaire with linear beam spread, horizontal

Superlight Nano 5, wide beam

Part number*	Colour	Light source	Luminous flux	Beam angle γ (FWHM)
8 830 046 059	black	25 x LED 2.3 W	3876 lm	66°
8 830 066 059	white	warm white (3000 K)		
8 830 056 059	silver grey			

8 830 045 059	black	25 x LED 2.3 W	4070 lm	66°
8 830 065 059	white	neutral white (4000 K)		
8 830 055 059	silver grey			

Part number*	Description	Beam angle γ (FWHM)
.4.	Luminaire with medium wide beam optics	32°

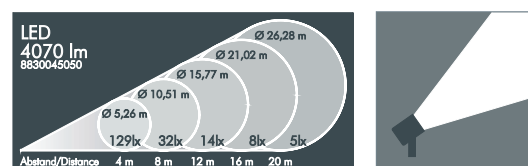
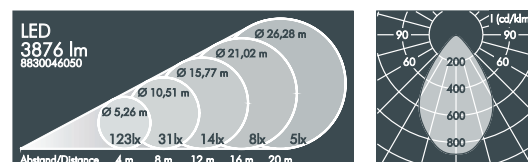

Part number*	Description
. 1..	Dimmable version (DALI)
. 2..	Dimmable version (1-10 V)
. 4..	Luminaire with 2 cable glands for through wiring

*Luminaires available with other light distributions on request

LED

Luminaires available in 2700 K and other colour temperatures on request



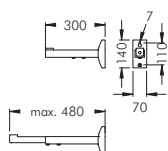

Accessories Superlight Nano

Part number	Colour	Description
128 0 700 940	black	Telescopic wall arm 300 - 480 mm,
128 0 700 960	white	aluminium, polyester powder coated
128 0 700 950	silver grey	

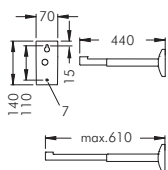

Part number	Colour	Description
128 0 730 940	black	Telescopic wall arm 440 - 610 mm,
128 0 730 960	white	aluminium, polyester powder coated
128 0 730 950	silver grey	

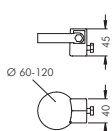

Part number	Colour	Description
128 0 760 940	black	Pole clamp, aluminium,
128 0 760 960	white	polyester powder coated, stainless steel strap,
128 0 760 950	silver grey	for mounting on poles Ø 60 - 120 mm

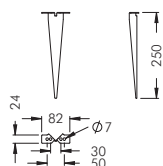

Part number	Colour	Description
129 0 502 940	black	Earth spike, stainless steel,
129 0 502 960	white	for use in landscaped areas
129 0 502 950	silver grey	

Accessories Superlight Nano 5

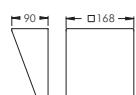

Part number	Colour	Description
128 0 862 940	black	Cowl, stainless steel,
128 0 862 960	white	to avoid glare from 3 directions,
128 0 862 950	silver grey	for retro-fitting

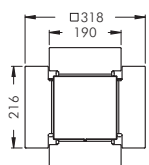

Part number	Colour	Description
128 0 861 940	black	Barn doors, aluminium,
128 0 861 960	white	to avoid glare from 4 directions,
128 0 861 950	silver grey	for retro-fitting



Part number	Colour	Description
128 0 860 941	black	Carrier frame,
128 0 860 961	white	with safety glass,
128 0 860 951	silver grey	for colour filters, lenses and plastic film



Part number	Description
238 1 242 000	Honeycomb louvre, internal (factory fitted, not for retro-fitting), to avoid glare

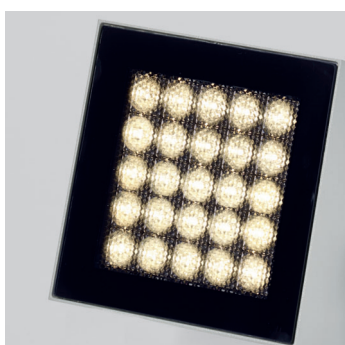

The internally fitted honeycomb louvre offers effective glare control and is protected from build up of dirt.



Willy Meyer+Sohn GmbH+Co. KG
Stemmessiepener Weg 5
58675 Hemer
Germany
Phone: +49 2372 9891-0
Fax: +49 2372 9891-48
E-mail: info@meyer-lighting.com
www.meyer-lighting.com

